

VENGEANCE

FIFTH WHEELS

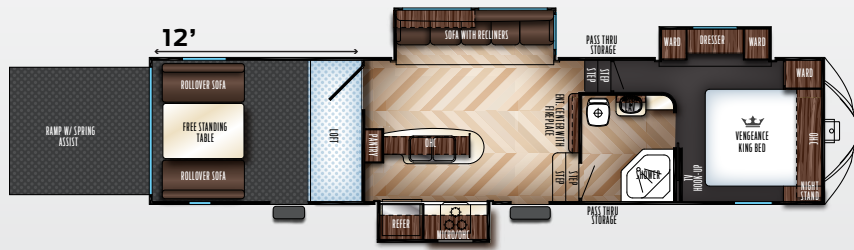

320A



348A13



377V



388V16

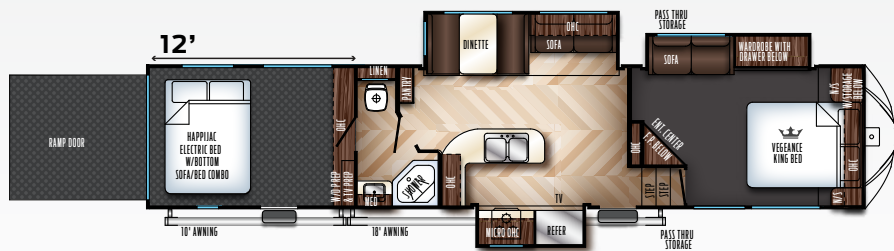

420V12

	320A	348A13	377V	388V16	420V12
Dry Hitch Weight	2398-lbs.	2718-lbs.	2646-lbs.	3380 lbs.	2888-lbs.
Unloaded Vehicle Weight	11939-lbs.	11995-lbs.	13275-lbs.	13429 lbs.	13362-lbs.
Axle Weight	9482-lbs.	9218-lbs.	10570-lbs.	???	10415-lbs.
GVWR w/Brakes	16000-lbs.	16398-lbs.	18000-lbs.	18000 lbs.	18000-lbs.
Cargo Carrying Capacity	4061-lbs.	4403-lbs.	4725-lbs.	4571 lbs.	4638-lbs.
Exterior Length	39'-8"	40'-10"	42'-4"	43' 10"	42'-8"
Exterior Height w/ AC	13'-4"	13'-4"	13'-4"	13' 4"	13'-4"
Exterior Width	102"	102"	102"	102"	102"
Grey Capacity	50-Gal.	80-Gal.	80-Gal.	100 gal.	100-Gal.
Black Capacity	50-Gal.	80-Gal.	80-Gal.	50 gal.	100-Gal.
Fresh Capacity	100-Gal.	100-gal	100-gal	100 gal.	100-gal
Awning Size	21'	21'	21'	18' & 10'	18' & 10'
Cargo Area Size-Off DS	146"	156"	144"	144"	144"
Cargo Area Size-DS	146"	156"	144"	144"	144"

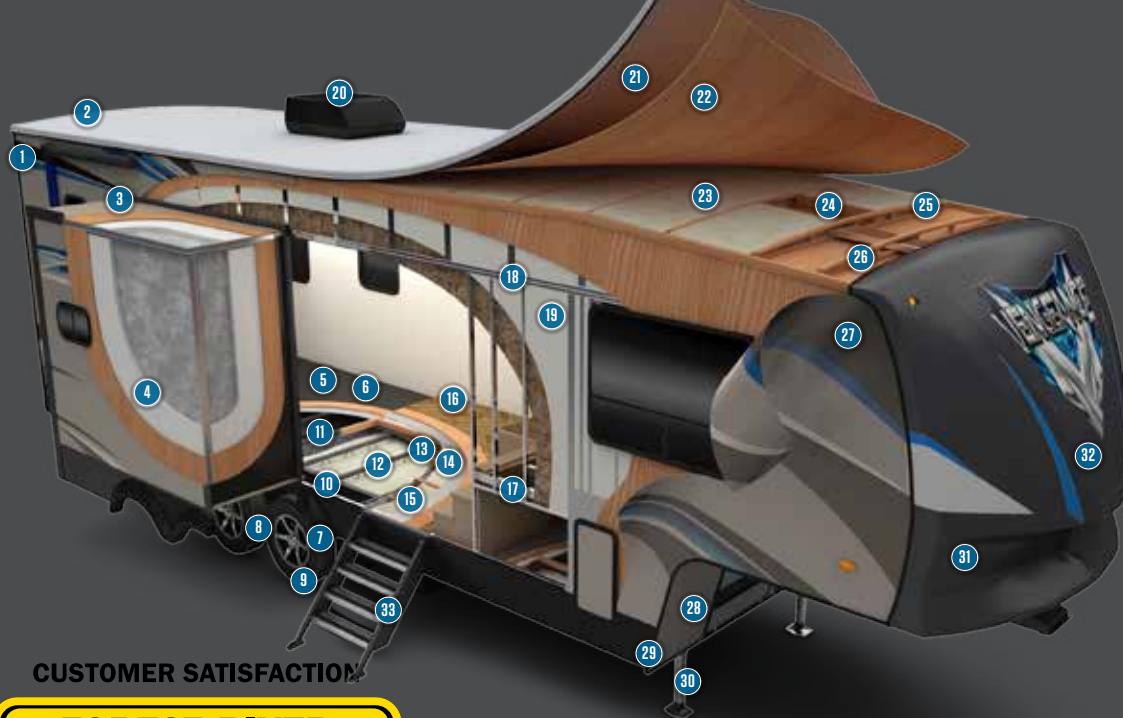

VENGEANCE CONSTRUCTION

QUALITY BUILT EVERY TIME.

- | | |
|---|---|
| 1 Dual power awnings w/ LED strip lighting (select floor plans) | 17 Aluminum framed laminated bed/bath floor |
| 2 Full walk-on roof | 18 2" Welded aluminum wall studs |
| 3 Aluminum framed, vacuum bonded, slide out roof | 19 Block foam wall insulation |
| 4 Aluminum framed, vacuum bonded, slide out side walls | 20 15,000 BTU A/C |
| 5 1" garage floor decking w/3,000 lb cargo capacity | 21 One piece PVC roof material |
| 6 "Dur-a-Poxy" EZ Clean Cargo Flooring in Garage | 22 3/8" Roof decking |
| 7 7,000 lb. Axles | 23 Baton insulation layer |
| 8 Equa Flex Suspension | 24 Bedroom A/C Prep |
| 9 Standard G-Rated Tires | 25 5" Bowed wood truss rafters |
| 10 True wide I-Beam chassis | 26 PVC foam A/C ducting |
| 11 Fluted polypropylene enclosed underbelly | 27 Vacuum bonded fiberglass side walls |
| 12 Baton insulation layer | 28 102" Wide body |
| 13 Polyethylene subfloor wrap | 29 Electric front landing gear on 2 axle models |
| 14 2x3 Wood floor joists | 30 Hydraulic Auto Leveling Option (Not Shown on Illustration) |
| 15 Baton insulation | 31 Aerodynamic front cap design |
| 16 Tongue in groove plywood floor | 32 Painted fiberglass front cap w/LED lighting |
| | 33 MORryde Step Above |

CUSTOMER SATISFACTION



www.ForestRiverBuyLocal.com

SUPERIOR FEATURES TOP TEN REASONS TO BUY

- 6 Sided Vacuum Bonded Walls
- Gray Gel-Coat Fiberglass Exterior
- Dexter (R) Torsion Axle
- Fully Walkable-Bonded Ceilings
- Fully welded Aluminum Super Structure
- Fully Enclosed and Heated Underbelly (Main Floor)
- Painted Fiberglass front cap w/LED's
- 30 Gallon Fuel Station and Gen Prep
- Mega Deep 7'2" Tall Slideouts
- LED interior lights and USB Charging Station

GVWR (Gross Vehicle Weight Rating) - is the maximum permissible weight of the unit when fully loaded. It includes all weights, inclusive of all fluids, cargo, optional equipment and accessories. For safety and product performance do NOT exceed the GVWR.

GAWR (Gross Axle Weight Rating) - is the maximum permissible weight, including cargo, fluids, optional equipment and accessories that can be safely supported by a combination of all axles.

UVW (Unloaded Vehicle Weight)* - is the typical weight of the unit as manufactured at the factory. It includes all weight at the unit's axle(s) and tongue or pin and LP Gas. The UVW does not include cargo, fresh potable water, additional optional equipment or dealer installed accessories.

*Estimated average based on standard build optional equipment.

CCC (Cargo Carrying Capacity)** - is the amount of weight available for fresh potable water, cargo, additional optional equipment and accessories. CCC is equal to GVWR minus UVW. Available CCC should accommodate fresh potable water (8.3 lbs per gallon). Before filling the fresh water tank, empty the black and gray tanks to provide for more cargo capacity.

** Estimated average based on standard build optional equipment

Each Forest River RV is weighed at the manufacturing facility prior to shipping. A label identifying the unloaded vehicle weight of the actual unit and the cargo carrying capacity is applied to every Forest River RV prior to leaving our facilities.

The load capacity of your unit is designated by weight, not by volume, so you cannot necessarily use all available space when loading your unit.

All information contained in this brochure is believed to be accurate at the time of publication. However, during the model year, it may be necessary to make revisions and Forest River, Inc., reserves the right to make all such changes without notice, including prices, colors, materials, equipment and specifications as well as the addition of new models and the discontinuance of models shown in this brochure. Therefore, please consult with your Forest River, Inc., dealer and confirm the existence of any materials, design or specifications that are material to your purchase decision. Litho. U.S.A. FOR 1490 P / W: 201712.12



Learn More
Scan this barcode using a QR Reader on your smart phone to learn more about Forest River.



A Berkshire Hathaway company.

YOUR VENGEANCE ROGUE DEALER



VENGEANCE

Touring Edition

FIFTH WHEELS

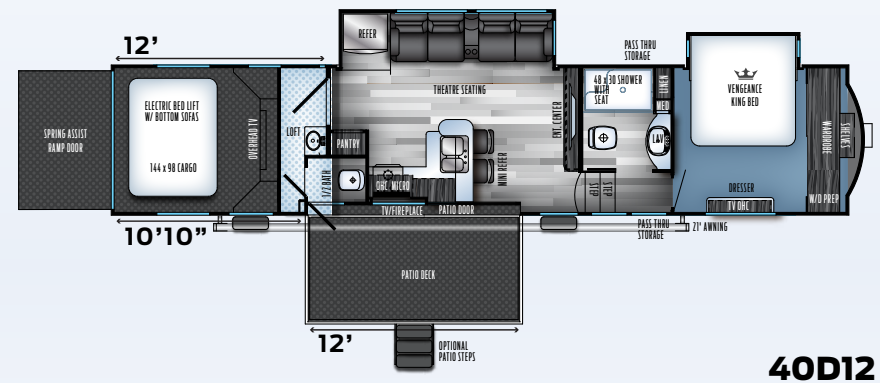
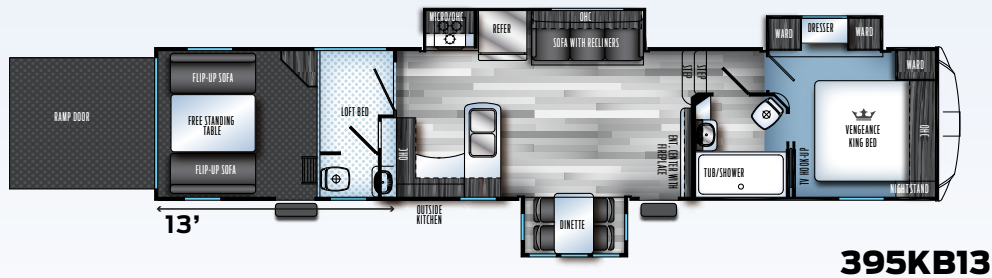
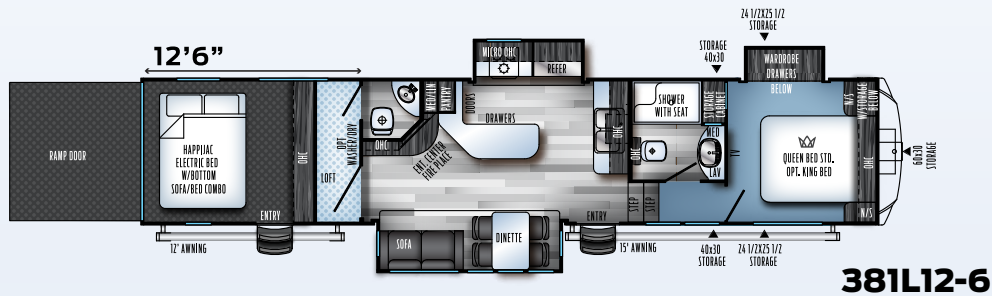

	381L12-6	40D12	395KB13
Dry Hitch Weight	2924-lbs	3234 lbs	2640 lbs
Unloaded Vehicle Weight	14221-lbs	14153 lbs	14529
Axle Weight	11238-lbs	10860 lbs	TBA
GVWR w/Brakes	19500-lbs	19500 lbs	19500
Cargo Carrying Capacity	5279-lbs	5347-lbs	4912
Exterior Length	43'-4"	42' 10"	44' 1"
Exterior Height w/ AC	13'-4"	13'-4"	13'-4"
Exterior Width	102"	102"	102"
Grey Capacity	100 gal	100 gal	80 gal
Black Capacity	100 gal	50 gal	80 gal
Fresh Capacity	100gal	100 gal	92 gal
Awning Size	15' & 12'	21'	TBA
Cargo Area Size-Off DS	150"	144"	156"
Cargo Area Size-DS	150"	120"	156"

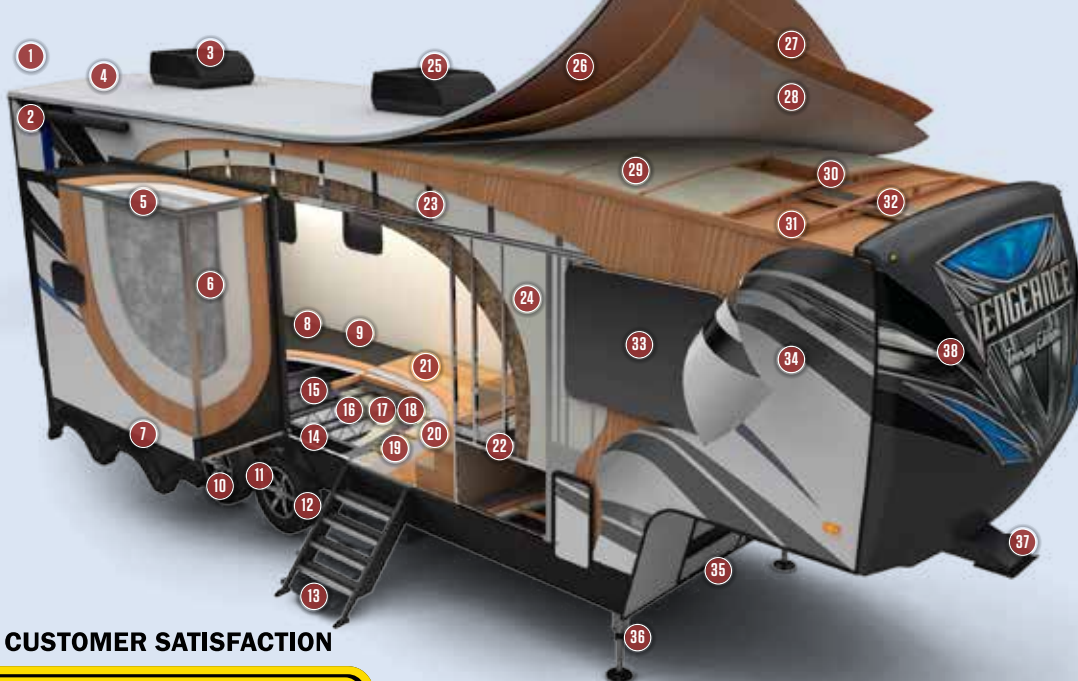

CUSTOMER SATISFACTION



www.ForestRiverBuyLocal.com

SUPERIOR FEATURES

TOP TEN REASONS TO BUY

- 1 102" Wide Body Construction
- 2 Fully Enclosed and Heated Underbelly w/ 12V Heated Holding Tank Pads on All Tanks
- 3 3,000# Garage Carrying Capacity w/ 5,000# Tie Downs
- 4 Trail Air Roto Flex Hitch Pin for Smooth Towing
- 5 40 Gallon Fuel Station w/ 5.5 Onan Generator
- 6 Triple AC units w/ Power Management
- 7 3 TV's and Fully Loaded Entertainment Package
- 8 Mega Deep 7'2" Tall Slideouts
- 9 Corian Countertops w/ Deep Stainless Steel Sink
- 10 Hardwood Raised Panel Cabinetry

GVWR (Gross Vehicle Weight Rating) - is the maximum permissible weight of the unit when fully loaded. It includes all weights, inclusive of all fluids, cargo, optional equipment and accessories. For safety and product performance do NOT exceed the GVWR.

GAWR (Gross Axle Weight Rating) - is the maximum permissible weight, including cargo, fluids, optional equipment and accessories that can be safely supported by a combination of all axles.

UVW (Unloaded Vehicle Weight)* - is the typical weight of the unit as manufactured at the factory. It includes all weight at the unit's axle(s) and tongue or pin and LP Gas. The UVW does not include cargo, fresh potable water, additional optional equipment or dealer installed accessories.

*Estimated average based on standard build optional equipment.

CCC (Cargo Carrying Capacity)** - is the amount of weight available for fresh potable water, cargo, additional optional equipment and accessories. CCC is equal to GVWR minus UVW. Available CCC should accommodate fresh potable water (8.3 lbs per gallon). Before filling the fresh water tank, empty the black and gray tanks to provide for more cargo capacity.

** Estimated average based on standard build optional equipment

Each Forest River RV is weighed at the manufacturing facility prior to shipping. A label identifying the unloaded vehicle weight of the actual unit and the cargo carrying capacity is applied to every Forest River RV prior to leaving our facilities.

The load capacity of your unit is designated by weight, not by volume, so you cannot necessarily use all available space when loading your unit.

All information contained in this brochure is believed to be accurate at the time of publication. However, during the model year, it may be necessary to make revisions and Forest River, Inc., reserves the right to make all such changes without notice, including prices, colors, materials, equipment and specifications as well as the addition of new models and the discontinuance of models shown in this brochure. Therefore, please consult with your Forest River, Inc., dealer and confirm the existence of any materials, design or specifications that are material to your purchase decision. Litho. U.S.A. FOR 1490 P / W: 201712.12

VENGEANCE TOURING EDITION CONSTRUCTION

QUALITY BUILT EVERY TIME.

- | | |
|--|---|
| 1 Rear power awning (not shown) | 20 Baton insulation |
| 2 Dual power awnings w/ LED strip lighting | 21 Tongue in groove plywood floor |
| 3 13,500 BTU rear A/C w/ 5,000 BTU heat strips | 22 Aluminum framed laminated bed/bath floor |
| 4 Full walk-on roof | 23 2" Welded aluminum wall studs |
| 5 Aluminum framed, vacuum bonded, slide out roof | 24 Block foam wall insulation |
| 6 Aluminum framed, vacuum bonded, slide out side walls | 25 15,000 BTU A/C |
| 7 Alumifoil insulated slide out floors | 26 One piece PVC roof material |
| 8 1" garage floor decking w/3,000 lb cargo capacity | 27 3/8" Roof decking |
| 9 Tuff ply cargo flooring in garage | 28 Alumifoil insulation layer |
| 10 7,000 lb. Axles | 29 Baton insulation layer |
| 11 Equa Flex Suspension | 30 13,500 BTU bedroom A/C |
| 12 Optional G-Rated Tires | 31 5" Bowed wood truss rafters |
| 13 MORryde Step Above (both entry doors) | 32 PVC foam A/C ducting |
| 14 True wide I-Beam chassis | 33 Frameless tinted windows |
| 15 Fluted polypropylene enclosed underbelly | 34 Vacuum bonded fiberglass side walls |
| 16 Alumifoil insulation layer | 35 102" Wide body |
| 17 Baton insulation layer | 36 6 point hydraulic self leveling |
| 18 Polyethylene subfloor wrap | 37 Trail air rotoflex hitch pin |
| 19 2x3 Wood floor joists | 38 Painted fiberglass front cap w/ LED Lighting |



Learn More
Scan this barcode using a QR Reader on your smart phone to learn more about Forest River.



A Berkshire Hathaway company.

YOUR VENGEANCE TOURING EDITION DEALER



VENGEANCE

ROGUE

FIFTH WHEELS & TRAVEL TRAILERS

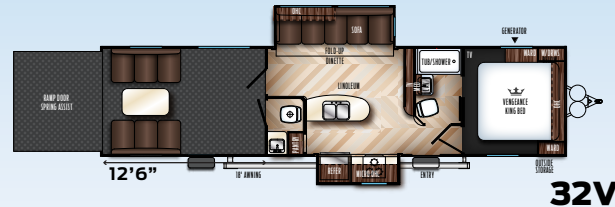
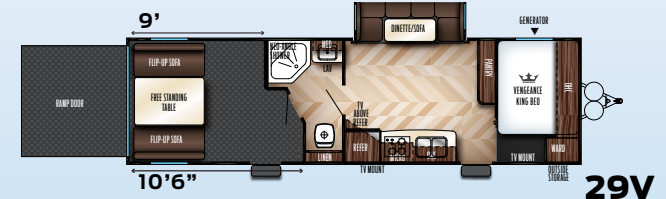
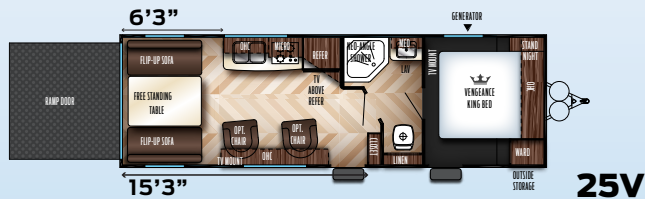

	25V	28V	29V	31V	32V	295A18	311A13	314A12
Dry Hitch Weight	1014-lbs.	926-lbs.	1210-lbs.	1250-lbs.	TBA	2084-lbs.	2317-lbs.	2466-lbs.
Unloaded Vehicle Weight	6498-lbs.	6604-lbs.	7789-lbs.	8484-lbs.	TBA	8997-lbs.	10258-lbs.	10879-lbs.
Axle Weight	5446-lbs.	5640-lbs.	6541-lbs.	7196-lbs.	TBA	6875-lbs.	7903-lbs.	8375-lbs.
GVWR w/Brakes	9985-lbs.	9985-lbs.	11370-lbs.	11410-lbs.	TBA	12996-lbs.	14257-lbs.	14466-lbs.
Cargo Carrying Capacity	3487-lbs.	3381-lbs.	3581-lbs.	2926-lbs.	TBA	3999-lbs.	3999-lbs.	3587-lbs.
Exterior Length	30' 6"	28'-5"	34'-6"	37'-1"	TBA	33'-4"	38'-4"	39'-2"
Exterior Height w/ AC	12'-1"	12'-1"	12'-1"	12' 4"	TBA	13'-4"	13'-4"	13'-4"
Exterior Width	102"	102"	102"	102"	TBA	102"	102"	102"
Grey Capacity	38-gal	38-gal	38-gal	38-gal	TBA	38-Gal.	38-Gal.	38-Gal.
Black Capacity	38-gal	38-gal	38-gal	38-gal	TBA	38-Gal.	38-Gal.	76-Gal.
Fresh Capacity	100 gal	100 gal	100 gal	100 gal	TBA	100-Gal.	100-Gal.	100-Gal.
Awning Size	21'	21'	21'	21'	TBA	21'	21'	21'
Cargo Area Size-Off DS	76"	75"	126"	120"	TBA	128"	158"	144"
Cargo Area Size-DS	184"	162"	108"	120"	TBA	225"	158"	144"

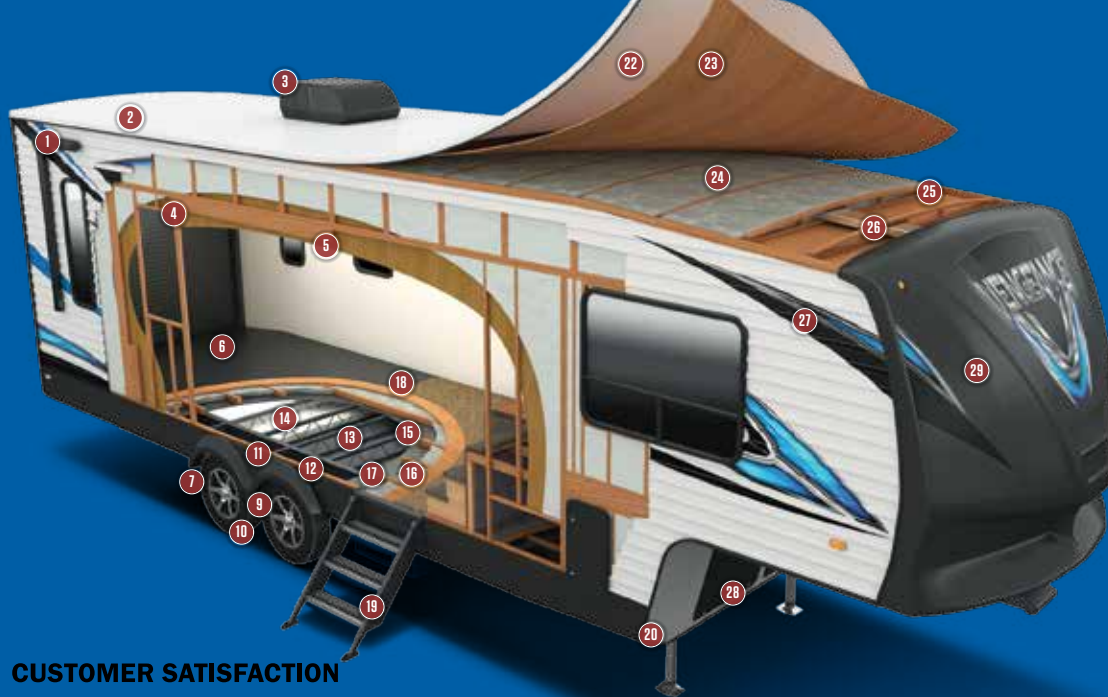

VENGEANCE ROGUE CONSTRUCTION

QUALITY BUILT EVERY TIME.

- | | |
|--|---|
| 1 Power awning w/ LED strip lighting | 18 Tongue in groove plywood floor |
| 2 Full walk-on roof | 19 MORryde Step Above |
| 3 13,500 BTU A/C | 20 Electric front landing gear (FW Only) |
| 4 2x2 Wood wall studs averaging 12" on center | 21 Stabilizer jacks (TT Only) |
| 5 5x2 Slide out headers (slide out models only) | 22 One piece PVC roof material |
| 6 Tuff ply cargo flooring in garage | 23 3/8" Roof decking |
| 7 6,000 lb. Axles (FW Only) | 24 Baton insulation layer |
| 8 5,200 lb Axles (TT Only) | 25 5" Bowed wood truss rafters |
| 9 Aluminum Rims | 26 PVC Foam A/C Ducting |
| 10 Radial Tires | 27 Aluminum Siding Std.
(Gel Coat Fiberglass Optional) |
| 11 Fender Skirts | 28 102" Wide body |
| 12 Steel I-Beam chassis | 29 Painted Fiberglass Front Cap (FW Only) |
| 13 Fluted polypropylene enclosed underbelly | 30 Smooth metal radius front (TT Only) |
| 14 Baton insulation layer in underbelly | 31 Diamond plate rock guard (TT Only) |
| 15 Polyethylene subfloor wrap | 32 LP Bottle Cover (TT Only) |
| 16 Baton insulation layer in floor | |
| 17 2x3 Wood floor joists averaging 12" on center | |

CUSTOMER SATISFACTION



www.ForestRiverBuyLocal.com

SUPERIOR FEATURES TOP TEN REASONS TO BUY

- 102" Wide Body Construction
- MORryde "Step Above" Steps
- Full Walk-on Roof
- Equa-flex Suspension
- PVC Foam A/C Ducts
- 8 CU Gas/Electric Refrigerator
- Seamless Countertops
- LED interior lights and USB charging ports
- Jensen Stereo Package w/ DVD
- Residential Amenities Throughout

GVWR (Gross Vehicle Weight Rating) - is the maximum permissible weight of the unit when fully loaded. It includes all weights, inclusive of all fluids, cargo, optional equipment and accessories. For safety and product performance do NOT exceed the GVWR.

GAWR (Gross Axle Weight Rating) - is the maximum permissible weight, including cargo, fluids, optional equipment and accessories that can be safely supported by a combination of all axles.

UVW (Unloaded Vehicle Weight)* - is the typical weight of the unit as manufactured at the factory. It includes all weight at the unit's axle(s) and tongue or pin and LP Gas. The UVW does not include cargo, fresh potable water, additional optional equipment or dealer installed accessories.

*Estimated average based on standard build optional equipment.

CCC (Cargo Carrying Capacity)** - is the amount of weight available for fresh potable water, cargo, additional optional equipment and accessories. CCC is equal to GVWR minus UVW. Available CCC should accommodate fresh potable water (8.3 lbs per gallon). Before filling the fresh water tank, empty the black and gray tanks to provide for more cargo capacity.

** Estimated average based on standard build optional equipment

Each Forest River RV is weighed at the manufacturing facility prior to shipping. A label identifying the unloaded vehicle weight of the actual unit and the cargo carrying capacity is applied to every Forest River RV prior to leaving our facilities.

The load capacity of your unit is designated by weight, not by volume, so you cannot necessarily use all available space when loading your unit.

All information contained in this brochure is believed to be accurate at the time of publication. However, during the model year, it may be necessary to make revisions and Forest River, Inc., reserves the right to make all such changes without notice, including prices, colors, materials, equipment and specifications as well as the addition of new models and the discontinuance of models shown in this brochure. Therefore, please consult with your Forest River, Inc., dealer and confirm the existence of any materials, design or specifications that are material to your purchase decision. Litho. U.S.A. FOR 1490 P / W: 2017.12.12



Learn More

Scan this barcode using a QR Reader on your smart phone to learn more about Forest River.



A Berkshire Hathaway company.

YOUR VENGEANCE ROGUE DEALER

LaMESA REC VAN

LaMesaRV.com
800-496-8778